

Smt. ...
 Member Secretary
 B.P.C.

- NOTES:
- BUILDING IS ARTIFICIALLY LIGHTED, MECHANICALLY VENTILATED, FULLY AIRCONDITIONED & HAS AUTOMATIC SPRINKLER SYSTEM ON ALL FLOORS
- FIRE LEGEND
- HOSE BOX ALONG WITH DELIVERY HOSE/BRANCH
 - HR FIRST AID HOSE REEL
 - ▽ CO2 FIRE EXTINGUISHER 45 Kg CAPACITY ISI MARK
 - ▽ WATER CO2 FIRE EXTINGUISHER 9 LTRS. CAP. ISI MARK
 - ⊠ MANUAL ALARM SYSTEM
 - ⊠ YARD HYDRANT
 - ⊠ FIRE SMOKE CHECK DOOR

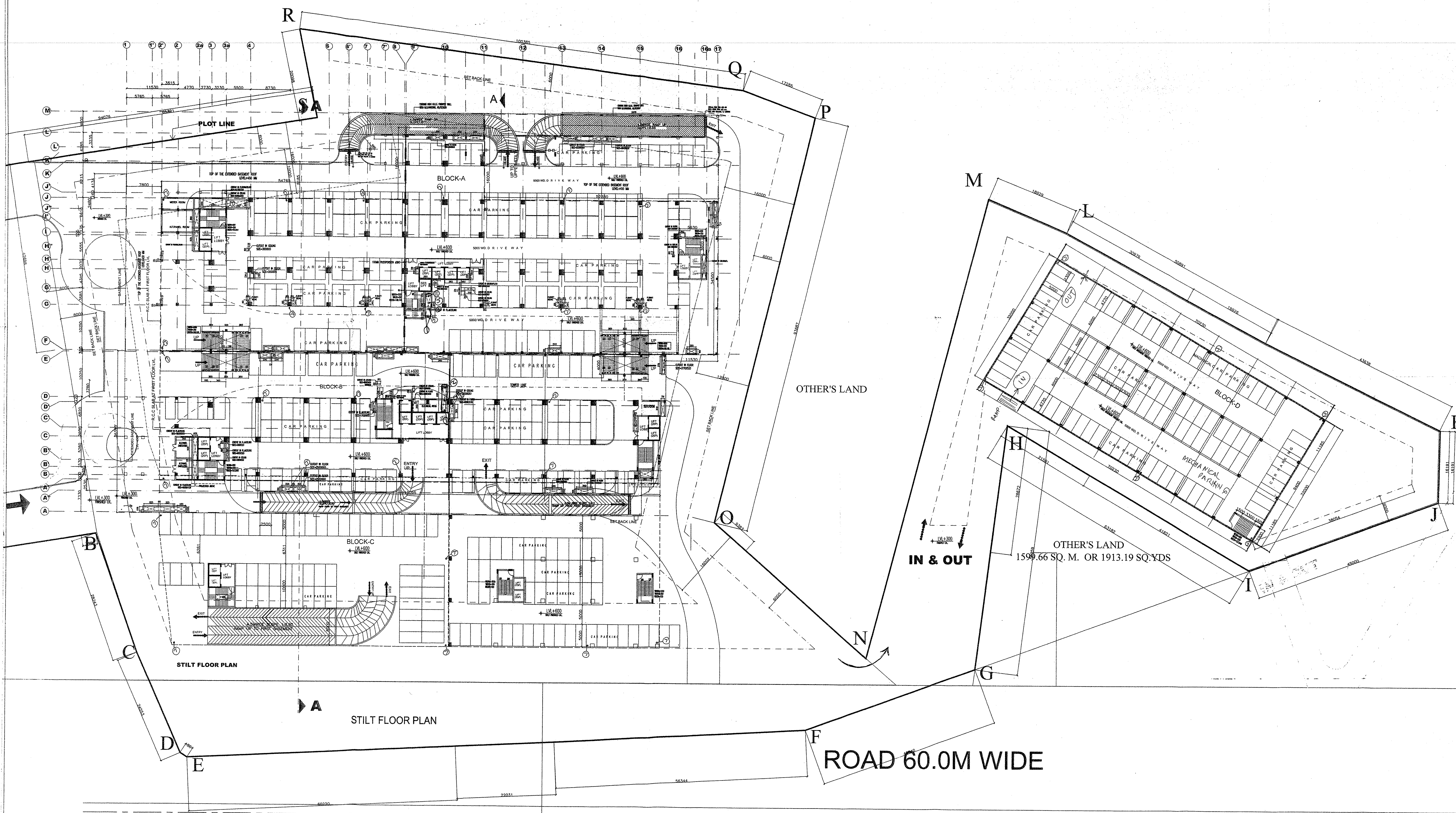

- SCHEDULE OF DOORS & WINDOWS
- D1=2000X2700
 - D2=900X2100
 - D3=900X2700
 - D4= 750X2100
 - DW1=3828X2700
 - DW2=6527X2700
 - DW3=6115X2700
 - DW4=5163X2700

OWNERS SEAL & SIGNATURE

For DOVE INFRASTRUCTURE PVT. LTD.
 Auth. Sign.

ARCHITECTS SEAL & SIGNATURE

Architect
PRADHEEP SINGH
 C.A. 91/23034
 and found ok for
 Public Health & Safety Services
 etc. as per...
 s.d.c. no. 201

PROJECT TITLE:

PROJECT :

I.T PARK MEASURING 8.5 ACES IN REVENUE ESTATE OF VILLAGE ANANGPUR, TEHSIL AND DISTRICT FARIDABAD, HARYANA. BELONGS TO M/S.DOVE INFRASTRUCTURE PVT.LTD.

FOR : M/S.DOVE INFRASTRUCTURE PVT.LTD.

DRAWING TITLE:

STILT FLOOR PLAN

DATE: APRIL-2009

SCALE: 1: 300

DRAWING NO:

6

N

AT MATHURA ROAD, FARIDABAD